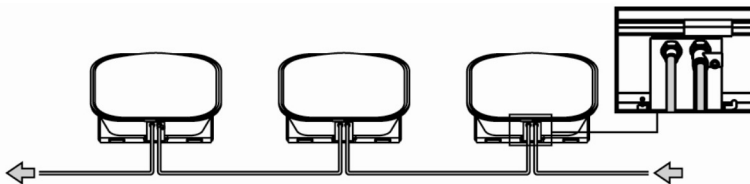
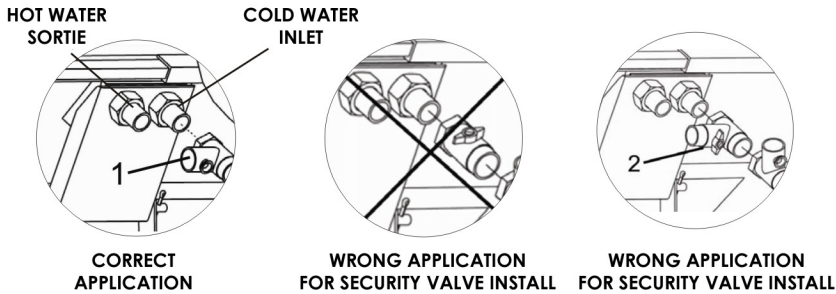

FIGURE 1

ANOD LIASON

## HOW TO TIE THE UNIT

Nanosol kit includes 3/4" hot water sortie pipe leading and cold water inlet pipe leading with 1 1/4" anode inlet. Between the two pipes, the one on the right is the cold water inlet pipe and the one on the left is the sortie of the hot water pipe. Wrong connection will decrease the efficiency of the system. Security valve needs to be installed in the cold water line, and install needs to be as seen in Figure 1.



If you need to install the units in serial, the liaison needs to follow the water afflux between the entry and the sortie of the water.